

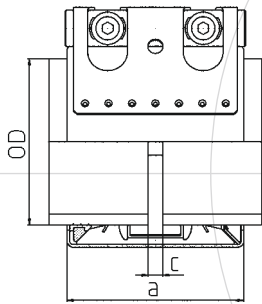

# NORMACONNECT® COMBI GRIP E

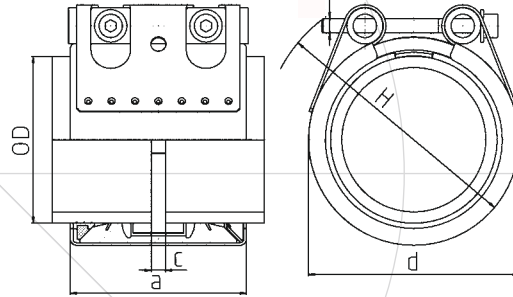

NORMACONNECT® COMBI GRIP



NORMACONNECT® COMBI GRIP E

OD COMBI GRIP/COMBI GRIP E (mm)	Clamping range		Clamping range		PN <sup>1)</sup>  (bar)	WP <sup>2)</sup>  (bar)	C <sub>max</sub> (mm)	Clamping range		
	OD <sub>min</sub> – OD <sub>max</sub> Plastics (mm)	OD <sub>min</sub> – OD <sub>max</sub> Metal (mm)	a (mm)	d clamped approx. (mm)				H approx. (mm)		
40.0/38.0	39.0 – 40.5	37.5 – 38.6	10	16	8	62	60	80		
40.0/42.4	39.0 – 40.5	41.7 – 43.0	10	16	8	62	65	85		
42.4/42.4	41.7 – 43.0	41.7 – 43.0	10	16	8	62	65	85		
48.3/48.3	47.6 – 50.5	47.6 – 50.5	10	16	8	62	70	90		
50.0/48.3	49.0 – 50.5	47.6 – 50.5	10	16	8	62	70	90		
60.3/60.3	59.5 – 61.0	59.5 – 61.0	10	16	17	78	85	105		
63.0/60.3	62.0 – 63.5	59.5 – 61.0	10	16	17	78	85	105		
73.0/73.0	72.0 – 74.0	72.1 – 73.8	10	16	25	98	95	115		
75.0/76.1	74.0 – 76.0	75.2 – 77.0	10	16	25	98	100	120		
88.9/88.9	88.0 – 90.0	87.0 – 89.9	10	16	25	98	110	130		
90.0/88.9	89.0 – 91.0	87.0 – 89.9	10	16	25	98	110	130		
101.6/101.6	100.4 – 102.8	100.4 – 102.8	10	16	25	98	125	145		
110.0/108.0	109.0 – 111.0	106.8 – 109.2	10	16	25	98	130	150		
110.0/114.3	109.0 – 111.0	113.0 – 115.5	10	16	25	98	135	155		
114.3/114.3	113.0 – 115.5	113.0 – 115.5	10	16	25	98	135	155		
125.0/129.0	124.0 – 126.0	127.6 – 131.1	10	16	35	115	150	170		
140.0/139.7	139.0 – 141.0	138.1 – 141.6	10	16	35	115	160	180		
141.3/141.3	138.1 – 141.6	139.6 – 142.8	10	16	35	115	165	185		
160.0/159.0	159.0 – 162.0	157.3 – 160.7	10	16	35	115	180	200		
168.3/168.3	166.5 – 170.1	166.5 – 170.1	10	16	35	115	190	210		
200.0/204.0	198.0 – 202.0	202.0 – 206.0	–	16	35	142	235	265		
219.1/219.1	217.0 – 222.0	216.0 – 221.0	–	16	35	142	250	280		
225.0/219.1	222.0 – 227.0	216.0 – 221.0	–	10	35	142	255	285		
225.0/222.0	222.0 – 227.0	220.0 – 224.0	–	10	35	142	255	285		
250.0/254.0	247.0 – 253.0	250.0 – 256.0	–	10	35	142	285	315		
273.0/273.0	271.0 – 276.0	270.0 – 275.0	–	10	35	142	305	335		
280.0/273.0	277.0 – 283.0	270.0 – 275.0	–	10	35	142	310	340		
323.9/323.9	320.0 – 327.0	320.0 – 327.0	–	6	35	142	355	385		
355.0/355.6	351.0 – 359.0	352.0 – 359.0	–	6	35	142	390	420		
400.0/406.4	396.0 – 404.0	402.0 – 410.0	–	6	35	142	440	470		
406.0/406.4	402.0 – 410.0	402.0 – 410.0	–	6	35	142	440	470		

<sup>1)</sup> PN (nominal pressure) is the max. admissible working pressure in shipbuilding, based on a safety factor of  $\geq 4$ .

<sup>2)</sup> WP is the max. working pressure in industrial applications, based on a safety factor as per NORMA specification.