

NORMACONNECT® FGR Materials

Components and materials in accordance with DIN standard

NORMACONNECT® pipe couplings are available in the materials W2, W4 and W5.

The support ring is only available in W5 material.

NORMACONNECT® Materials Summary • Table contents = DIN-values only.

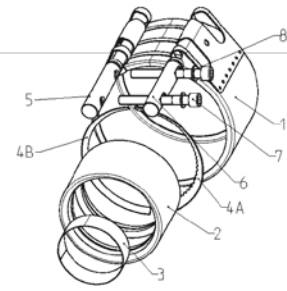

W2						
No.	Component	FLEX/FLEX E	GRIP/GRIP E	COMBI GRIP/ COMBI GRIP E	PLAST GRIP/ PLAST GRIP E	REP E
1	Housing with bridge	1.4301	1.4301	1.4301	1.4301	1.4301
2	Sealing sleeve	EPDM/NBR	EPDM/NBR	EPDM/NBR	EPDM/NBR	EPDM/NBR
3	Strip insert ¹⁾	1.4571/PA-GF	1.4571/PA-GF	1.4571/PA-GF	1.4571/PA-GF	1.4571
4 A	Anchoring ring for metal pipes ²⁾	–	1.4310	1.4310	–	–
4 A	Anchoring ring for plastic pipes ²⁾	–	–	PA-GF-NS ³⁾	PA-GF-NS ³⁾	–
4 B	Protection ring	1.4571	–	–	–	–
5 + 6	Solid lock bars	1.0715	1.0715	1.0715	1.0715	1.0715
5 + 6	Hollow lock bars	1.0580	1.0580	1.0580	1.0580	1.0580
7	Locking bolts	10,9	10,9	10,9	10,9	10,9
8	Washer	A4-80	A4-80	A4-80	A4-80	A4-80

W4						
No.	Component	FLEX/FLEX E	GRIP/GRIP E	COMBI GRIP/ COMBI GRIP E	PLAST GRIP/ PLAST GRIP E	REP E
1	Housing with bridge	1.4301	1.4301	1.4301	1.4301	1.4301
2	Sealing sleeve	EPDM/NBR	EPDM/NBR	EPDM/NBR	EPDM/NBR	EPDM/NBR
3	Strip insert ¹⁾	1.4571/PA-GF	1.4571/PA-GF	1.4571/PA-GF	1.4571/PA-GF	1.4571
4 A	Anchoring ring for metal pipes ²⁾	–	1.4310	1.4310	–	–
4 A	Anchoring ring for plastic pipes ²⁾	–	–	PA-GF-NS ³⁾	PA-GF-NS ³⁾	–
4 B	Protection ring	1.4571	–	–	–	–
5 + 6	Solid lock bars	1.4404	1.4404	1.4404	1.4404	1.4404
5 + 6	Hollow lock bars	1.4571	1.4571	1.4571	1.4571	1.4571
7	Locking bolts	A4-80	A4-80	A4-80	A4-80	A4-80
8	Washer	A4-80	A4-80	A4-80	A4-80	A4-80

W5						
No.	Component	FLEX/FLEX E FLEX 3	GRIP/GRIP E GRIP E-FP	COMBI GRIP/ COMBI GRIP E	PLAST GRIP/ PLAST GRIP E	REP E
1	Housing with bridge	1.4571	1.4571	1.4571	1.4571	1.4571
2	Sealing sleeve	EPDM/NBR	EPDM/NBR	EPDM/NBR	EPDM/NBR	EPDM/NBR
3	Strip insert ¹⁾	1.4571/PA-GF	1.4571/PA-GF	1.4571/PA-GF	1.4571/PA-GF	1.4571
4 A	Anchoring ring for metal pipes ²⁾	–	1.4310	1.4310	–	–
4 A	Anchoring ring for plastic pipes ²⁾	–	–	PA-GF-NS ³⁾	PA-GF-NS ³⁾	–
4 B	Protection ring	1.4571	–	–	–	–
5 + 6	Solid lock bars	1.4404	1.4404	1.4404	1.4404	1.4404
5 + 6	Hollow lock bars	1.4571	1.4571	1.4571	1.4571	1.4571
7	Locking bolts	A4-80	A4-80	A4-80	A4-80	A4-80
8	Washer	A4-80	A4-80	A4-80	A4-80	A4-80

¹⁾ PA-GF plastic strip inserts are only for pipe couplings used in shipbuilding applications.

²⁾ COMBI GRIP couplings are equipped with two different anchoring rings (1 x for the metal end, 1 x for the plastic end).

³⁾ PA-GF: PA reinforced with fibre glass; NS: new silver.

Sealing sleeves: Areas of application & temperature resistance

Material of seal	EPDM	NBR
Temperature range	-30 °C up to +125 °C OD 26.9 up to 168,3 mm -20 °C up to +80 °C OD > 180 mm	-20 °C up to +80 °C
Media	Drinking water Alcohols Compressed air Solids	Water Oils Gases (combustible) Fuels Hydrocarbon solutions

