

NORMAFIX® – Retaining Products

NORMAFIX® NORMETTA® Continuous band clamping system

The NORMAFIX® NORMETTA® clamping system consists of a continuous band which fits nearly any shape and size of the objects to be retained or clamped. In addition there is a choice of five different closure types (buckles).

The NORMAFIX® NORMETTA® clamping system is particularly suitable for fixing and/or repair purposes under difficult or extraordinary conditions.

Short description of technical features

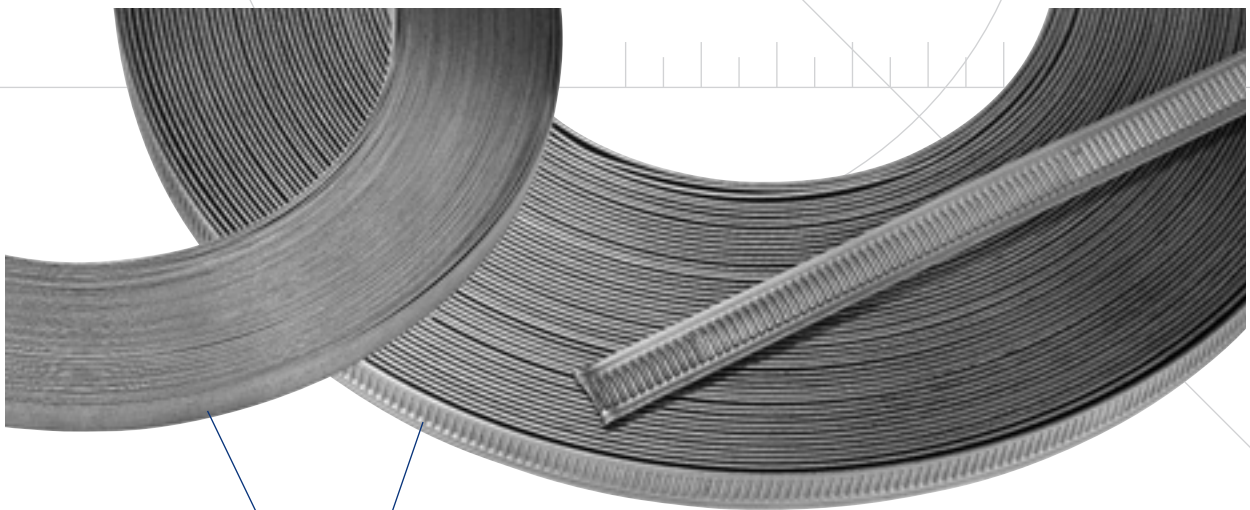

Continuous band, either smooth or stamped worm-drive band = flexible and suitable for use in many applications

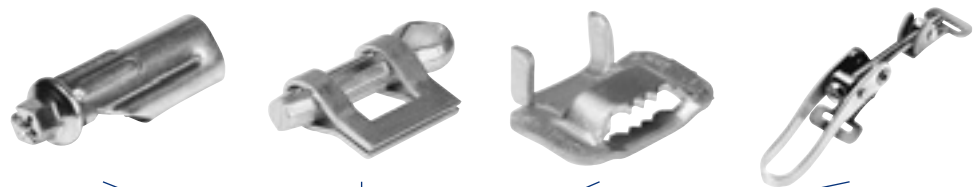

5 different closure types available to fit various applications

Materials

W1	W2	W3	W4	W5
x		x	x	

NORMAFIX® – Retaining Products

The Band and Closure Types

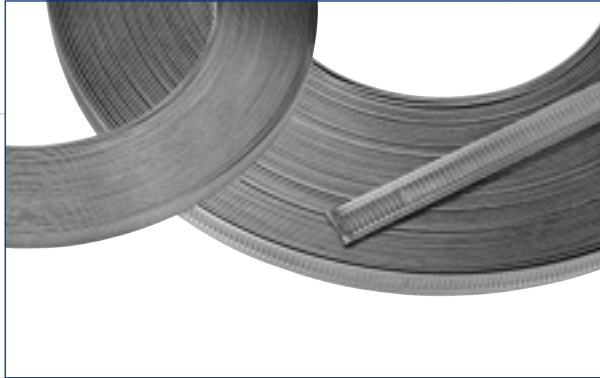

We supply the continuous band in 30 m coils either as smooth band in various band widths or as stamped worm-drive band (only 13 mm) in different material qualities.

You can choose from 5 closure types:

NB-A

Material: W1
for band width
5, 9 mm



Buckle type **NB-A**

is suitable for lighter applications such as fixing smaller signs and sealing low-pressure hoses.
Reusable.

Required tools: Steel pin, 90° offset screw driver or pliers, tin snips.

NB-D

Material: W4
for band width
9, 13, 16, 19 mm



Buckle type **NB-D**

is suitable for fixing signs, containers and pipes as well as for sealing hoses.

Required tools: Tightening and cutting tool, hammer.

NORMAFIX® – Retaining Products

NB-G

Material: W1, W3
for worm-drive
band



Buckle type **NB-G**
for worm-drive ~~13~~ mm band. Suitable for applications in
tight conditions. **12**
Reusable.

Required tools: Screwdriver or hexagonal wrench SW 7 and
tin snips.

NB-H

Material: W1
for band width
16, 19 mm



Buckle type **NB-H**
is an adjustable quick-release buckle and enables quick and
simple assembly and disassembly.
Reusable.

Required tools: Screwdriver and tin snips.

Applications

- Retaining, sealing and repairing pipes
- Retaining signs and containers
- Sealing hoses

The advantages at a glance

- Flexible, multi-purpose system
- Ease of assembly even in narrow spaces

NORMAFIX® – Retaining Products

Tools

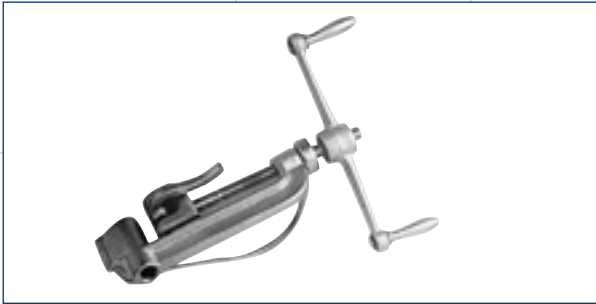

1 Clamping and Cutting Tool

We recommend this high-quality tool for professional use. It is easy to handle and can withstand tension forces of up to approx. 10,000 N (1,000 KP).

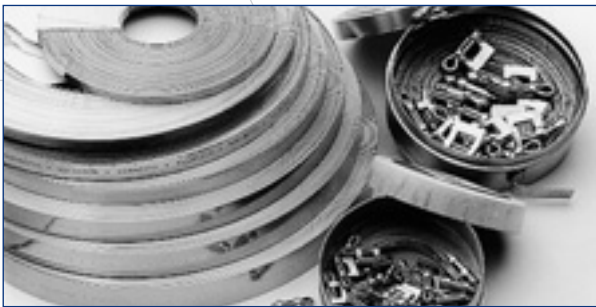

2 Mini Repair Kits

- 5 pieces Contents = 8 m band W1, 5 mm wide plus 25 buckles type NB-45.
Part number 560 8520 003
- 9 pieces Contents = 8 m band W1, 9 mm wide plus 25 buckles type NB-A9.
Part number 560 8520 001

Survey of sizes, band widths & materials

NORMAFIX® NORMETTA®

Coil with 30 m Band					Appropriate Buckle Type			
Band width (mm)	Band thickness	W 1 (zinc plated mild steel)	W 3 (1.4016)	W 4 (1.4371)	NB-A	NB-D	NB-G	NB-H
5	0.35	560 8500 004	–	–	NB-A5 W1	–	–	–
9	0.40	560 8500 001	–	–	NB-A9 W1	NB-D9 W4	–	–
	0.55*	–	–	560 8554 009	–	NB-D9 W4	–	–
13	0.70*	–	–	560 8553 013	–	NB-D13 W4	–	–
12 pressed	0.80	560 8566 001	–	–	–	–	NB-G12 W1	–
	0.80	–	560 8566 003	–	–	–	NB-G12 W3	–
16	0.70*	–	–	560 8553 016	–	NB-D16 W4	–	NB-H16 W1
19	0.70*	–	–	560 8553 019	–	NB-D19 W4	–	NB-H19 W1

* also available in 1.4301 material

Enquiries/ordering:

When making enquiries or placing an order please state as follows:

	1. Order code/coil	2. Order code/buckle
Example	560 8554 009	NB-D9 W4